

duo.sprint – Set-up instructions

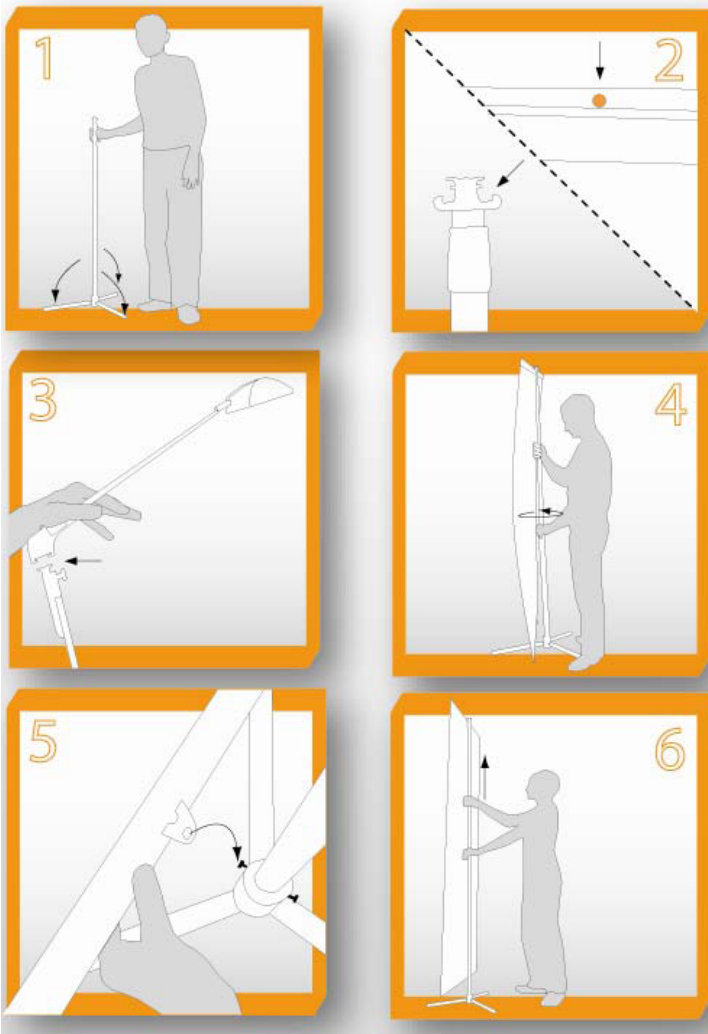

- 1. Automatic set-up of the base**
The tripod feet linked with a bungee cord for quick, simple and secure automatic set-up.
- 2. Adjust the graphic on top of the pole**
Insert the hanger on the pole- the orange sticker is at the middle.
- 3. Insert the floodlight**
A floodlight can be inserted on the special groove located on the head of the pole.
- 4. Lock the height with twist-lock**
The state of the art spin-lock mechanism on the telescopic pole for an easy height adjustment without tools.
- 5. Attach the graphic on the bottom pin**
The adjustable ring is a sliding part on the pole secured without any tool. It offers great versatility in graphics sizes.
- 6. Secure the tension of the graphic**
The high-gripping plastic twisting locks prevents the pole from sliding down once extended.

The duo.sprint is available for purchase online at
SpeedyDisplays.com, a Schantz Inc. company.